

LMC1005 SERIES



<http://www.abco.co.kr>

LMC1005 SERIES

■ SHAPE & DIMENSIONS / RECOMMENDED SOLDER LAND PATTERN

(Unit : mm)

BOTTOM VIEW

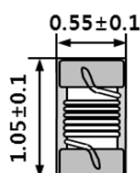

SIDE VIEW

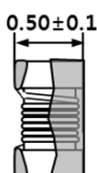

※PCB PATTERNS



■ ELECTRICAL CHARACTERISTICS

Ordering code	Inductance [nH]	Tolerance (%)	Q (min.)	SRF Min. (MHZ)	Rdc Max. (Ω)	Idc Max. (mA)
LMC1005TP - 1N0○	1.0@ 250MHZ	± 10,5	9	6000	0.080	1360
LMC1005TP - 1N7○	1.7@ 250MHZ	± 10,5	15	6000	0.050	1060
LMC1005TP - 1N8○	1.8@ 250MHZ	± 10,5	15	6000	0.050	1060
LMC1005TP - 2N0○	2.0@ 250MHZ	± 10,5	16	6000	0.070	1040
LMC1005TP - 2N2○	2.2@ 250MHZ	± 10,5	19	6000	0.070	960
LMC1005TP - 2N3○	2.3@ 250MHZ	± 10,5	10	6000	0.090	800
LMC1005TP - 2N4○	2.4@ 250MHZ	± 10,5	10	6000	0.090	760
LMC1005TP - 2N7○	2.7@ 250MHZ	± 10,5	19	6000	0.045	520
LMC1005TP - 3N3○	3.3@ 250MHZ	± 10,5	19	6000	0.066	840
LMC1005TP - 3N6○	3.6@ 250MHZ	± 10,5	19	6000	0.066	840
LMC1005TP - 3N9○	3.9@ 250MHZ	± 10,5	19	5800	0.066	840
LMC1005TP - 4N3○	4.3@ 250MHZ	± 10,5	19	6000	0.091	700
LMC1005TP - 4N7○	4.7@ 250MHZ	± 10,5	20	5800	0.070	800
LMC1005TP - 5N1○	5.1@ 250MHZ	± 10,5	20	5800	0.083	800
LMC1005TP - 5N6○	5.6@ 250MHZ	± 10,5	20	5800	0.083	760
LMC1005TP - 6N2○	6.2@ 250MHZ	± 10,5	20	5800	0.083	760
LMC1005TP - 6N6○	6.6@ 250MHZ	± 10,5	22	5800	0.100	760
LMC1005TP - 6N8○	6.8@ 250MHZ	± 10,5	22	5800	0.100	760
LMC1005TP - 7N3○	7.3@ 250MHZ	± 10,5	22	5800	0.170	700
LMC1005TP - 7N5○	7.5@ 250MHZ	± 10,5	22	5800	0.104	680
LMC1005TP - 8N2○	8.2@ 250MHZ	± 10,5	22	4400	0.104	680
LMC1005TP - 9N0○	9.0@ 250MHZ	± 10,5	22	4160	0.130	680
LMC1005TP - 9N1○	9.1@ 250MHZ	± 10,5	22	4160	0.130	680
LMC1005TP - 10N○	10@ 250MHZ	± 10,5	21	3900	0.195	480
LMC1005TP - 11N○	11@ 250MHZ	± 10,5	24	3680	0.120	640
LMC1005TP - 12N○	12@ 250MHZ	± 10,5	24	3600	0.160	640
LMC1005TP - 13N○	13@ 250MHZ	± 10,5	25	3600	0.120	630
LMC1005TP - 14N○	14@ 250MHZ	± 10,5	24	3350	0.160	590
LMC1005TP - 15N○	15@ 250MHZ	± 10,5	24	3280	0.172	560
LMC1005TP - 16N○	16@ 250MHZ	± 10,5	24	3200	0.210	530
LMC1005TP - 18N○	18@ 250MHZ	± 10,5	24	3100	0.190	520
LMC1005TP - 19N○	19@ 250MHZ	± 10,5	24	3040	0.260	480
LMC1005TP - 20N○	20@ 250MHZ	± 10,5	24	2950	0.270	450
LMC1005TP - 22N○	22@ 250MHZ	± 10,5	24	2840	0.300	390
LMC1005TP - 23N○	23@ 250MHZ	± 10,5	24	2720	0.280	400
LMC1005TP - 24N○	24@ 250MHZ	± 10,5	24	2580	0.350	380
LMC1005TP - 25N○	25@ 250MHZ	± 10,5	24	2550	0.350	380
LMC1005TP - 27N○	27@ 250MHZ	± 10,5	24	2480	0.330	400
LMC1005TP - 30N○	30@ 250MHZ	± 10,5	24	2400	0.400	350
LMC1005TP - 33N○	33@ 250MHZ	± 10,5	25	2400	0.480	300
LMC1005TP - 36N○	36@ 250MHZ	± 10,5	24	2320	0.480	320

○ : J(±5%), K(±10%)

Specifications given herein may be changed at any time without prior notice. Please confirm technical specifications before your order and/or use.

LMC1005 SERIES



<http://www.abco.co.kr>

LMC1005 SERIES

Ordering code	Inductance [nH]	Tolerance (%)	Q (min.)	SRF Min. (MHZ)	Rdc Max. (Ω)	Idc Max. (mA)
LMC1005TP - 39N○	39@ 250MHZ	± 10,5	24	2260	0.490	320
LMC1005TP - 40N○	40@ 250MHZ	± 10,5	24	2240	0.550	320
LMC1005TP - 47N○	47@ 250MHZ	± 10,5	20	2210	0.830	150
LMC1005TP - 51N○	51@ 250MHZ	± 10,5	23	2180	0.850	120
LMC1005TP - 56N○	56@ 250MHZ	± 10,5	22	2160	1.400	100
LMC1005TP - 68N○	68@ 250MHZ	± 10,5	22	2020	1.700	92
LMC1005TP - 82N○	82@ 250MHZ	± 10,5	20	1940	1.900	84
LMC1005TP - 91N○	91@ 100MHZ	± 10,5	20	2100	2.330	125
LMC1005TP - R10○	100@ 100MHZ	± 10,5	18	1900	3.500	120

○ : J(±5%), K(±10%)

▼ Test Equipments

- Inductance measured : RF LCR Meter HP4287A + 16197A Fixture or equivalent
- Q Measured : RF LCR Meter HP4287A + 16197A Fixture or equivalent
- SRF Measured : NETWORK ANALYZER(HP8753D)+ABCO SMD-D test fixture or equivalent
- RDC Measured : RF LCR Meter HP4287A + 16197A Fixture or equivalent
- IDC For 15°C rise : Agilent 6692A 0-60V/0-110A SYSTEM DC POWER SUPPLY
+YOKOGAWA DR130 HYBRID RECORDER or equivalent U89