

ABCO Bead COMPONENTS

EDMC321611-BK Series



5448-4, Sangdaewon-dong, Jungwon-gu,
Seongnam-si, Gyeonggi-do, KOREA

Sales Dept. TEL:82-31-730-5082

FAX:82-31-730-5152

Eng. Dept. TEL:82-31-730-5053

FAX:82-31-730-5153

ABCO ELECTRONICS CO., LTD.

EDMC321611-BK Series



<http://www.abco.co.kr>

■ Features

1. This specification applies to MULTILAYER FERRITE CHIP BEADS
2. Operating temperature -55°C ~ +125°C. (Including self - temperature rise)

■ Ordering Code

EDMC **321611** **T** - **700** **Y** - **BK**

① ② ③ ④ ⑤ ⑥

| ① Type | |
|--------|--|
| EDMC | |

| ② Dimensions(mm) |
|-----------------------------------|
| 321611 : 3.2(L) × 1.6(W) × 1.1(T) |

| ③ Packing | |
|-----------|--------|
| T | TAPING |

| ④ Impedance(Ω) | |
|----------------|------|
| 700 | 70 |
| 121 | 120 |
| 102 | 1000 |

| ⑤ Tolerance |
|-------------|
| Y : ±25% |

| ⑥ Internal Code |
|-----------------|
| BK |

EDMC321611-BK Series



<http://www.abco.co.kr>

▣ Shapes and Dimensions

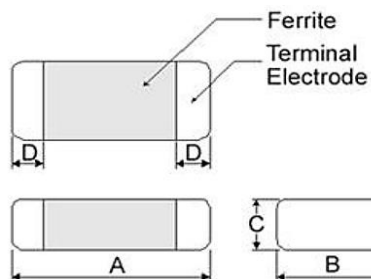

▣ Recommended PC Board Pattern

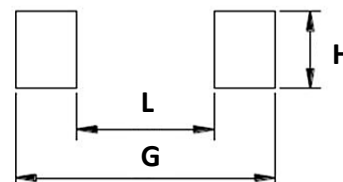

| Series | A(mm) | B(mm) | C(mm) | D(mm) |
|---------------|---------|---------|---------|---------|
| EDMC321611-BK | 3.2±0.2 | 1.6±0.2 | 1.1±0.2 | 0.5±0.3 |

| L(mm) | G(mm) | H(mm) |
|---------|---------|---------|
| 2.0~2.4 | 4.2~5.2 | 1.3~1.9 |

▣ Electrical Characteristics

| Part Number | Impedance ($\Omega \pm 25\%$) | Test Frequency (MHz) | RDC (Ω) Max. | Rated Current(mA) |
|---------------------|------------------------------------|-------------------------|-----------------------------|------------------------------------|
| | | | | $\Delta T = 30^\circ\text{C}$ Max. |
| EDMC321611T-700Y-BK | 70 | 100 | 0.10 | 500 |
| EDMC321611T-800Y-BK | 80 | 100 | 0.15 | 500 |
| EDMC321611T-900Y-BK | 90 | 100 | 0.15 | 500 |
| EDMC321611T-101Y-BK | 100 | 100 | 0.15 | 500 |
| EDMC321611T-121Y-BK | 120 | 100 | 0.15 | 500 |
| EDMC321611T-151Y-BK | 150 | 100 | 0.15 | 500 |
| EDMC321611T-221Y-BK | 220 | 100 | 0.20 | 400 |
| EDMC321611T-301Y-BK | 300 | 100 | 0.20 | 400 |
| EDMC321611T-401Y-BK | 400 | 100 | 0.20 | 400 |
| EDMC321611T-471Y-BK | 470 | 100 | 0.20 | 400 |
| EDMC321611T-501Y-BK | 500 | 100 | 0.20 | 400 |
| EDMC321611T-601Y-BK | 600 | 100 | 0.30 | 400 |
| EDMC321611T-102Y-BK | 1000 | 50 | 0.40 | 200 |
| EDMC321611T-122Y-BK | 1200 | 50 | 0.40 | 200 |
| EDMC321611T-152Y-BK | 1500 | 50 | 0.45 | 200 |
| EDMC321611T-202Y-BK | 2000 | 30 | 0.60 | 200 |
| EDMC321611T-272Y-BK | 2700 | 30 | 0.60 | 300 |

1. Testing Instrument

- Impedance : HP4291A
- RDC :HP4338B or CHEN HWA 502

2. Rate Current : Applied the current to coils, the temperature rise shall not be more than 30°C

Specifications given herein may be changed at any time without prior notice. Please confirm technical specifications before your order and/or use.

EDMC321611-BK Series



<http://www.abco.co.kr>

Graph

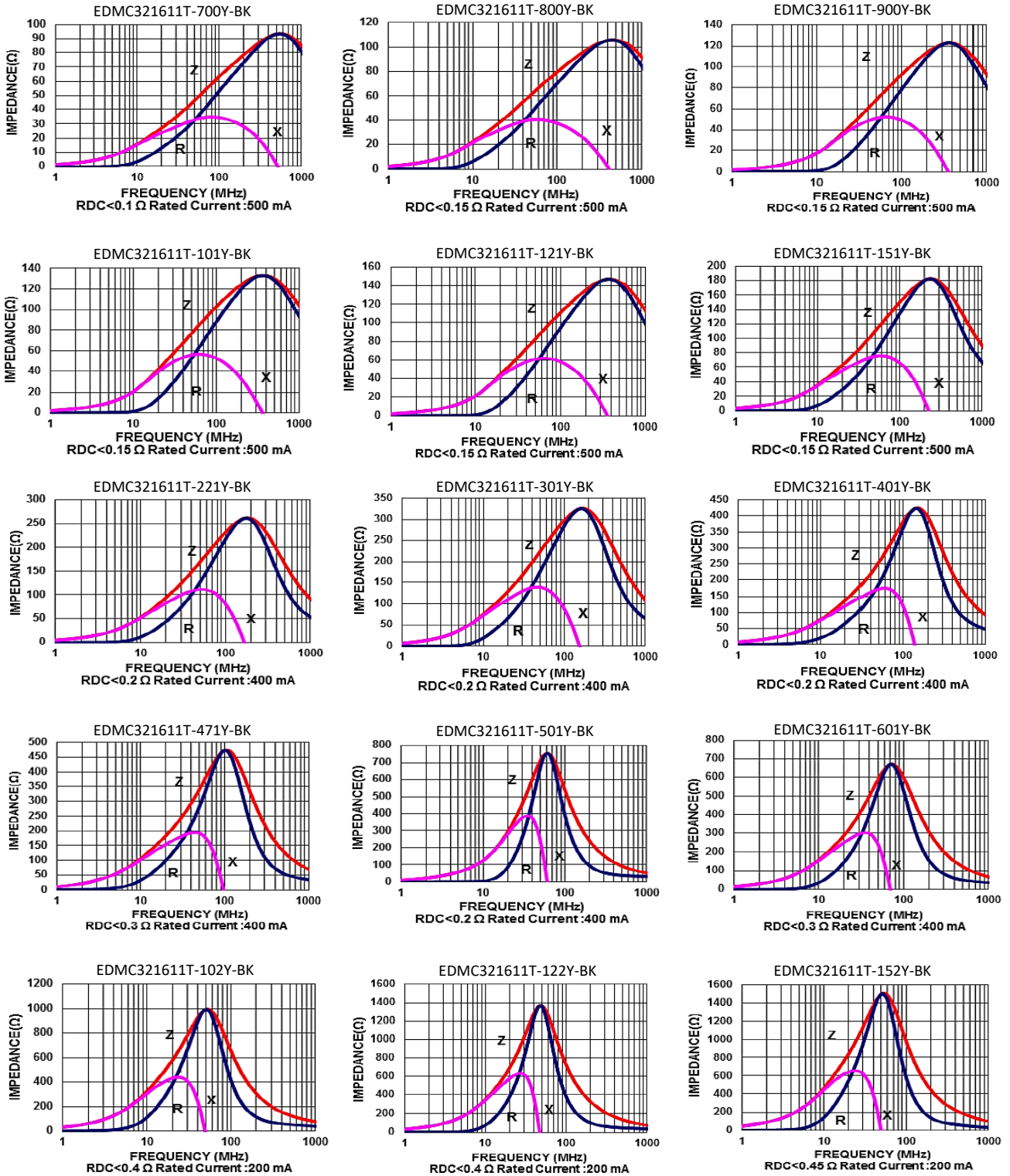

Specifications given herein may be changed at any time without prior notice. Please confirm technical specifications before your order and/or use.

EDMC321611-BK Series



<http://www.abco.co.kr>

Graph

